

# CP4 Robotics Control Panel

CP4 Robotics Control Panel

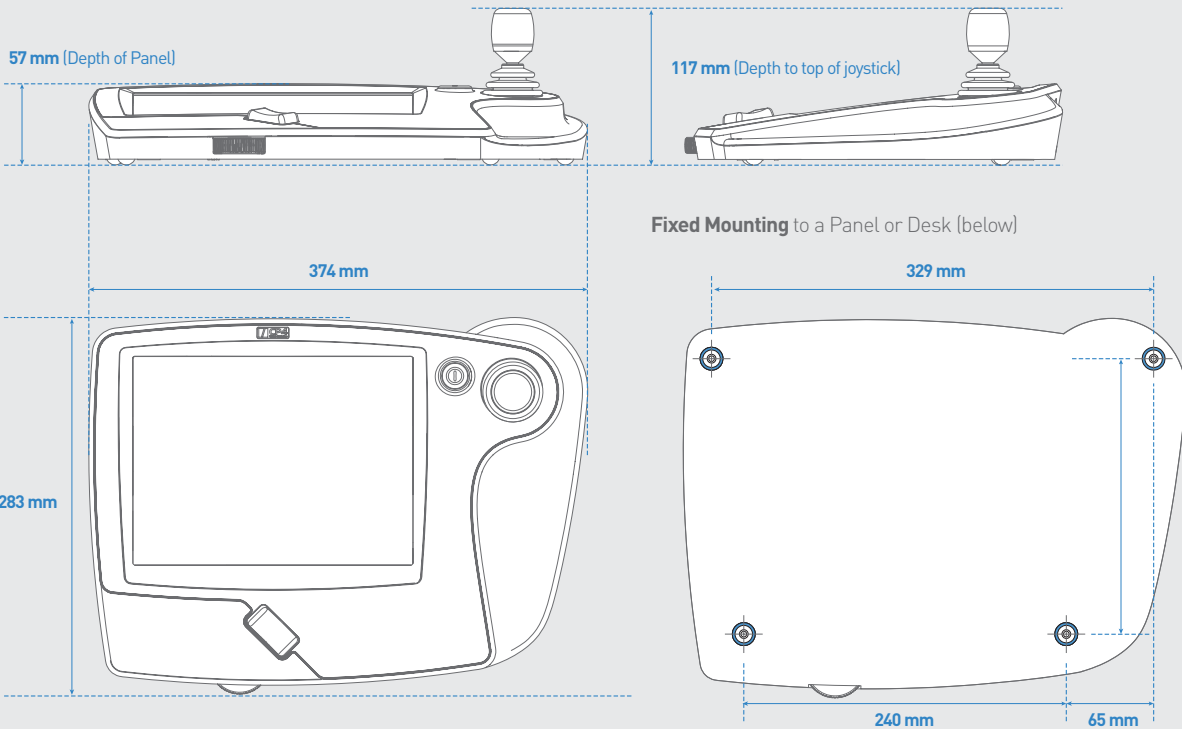
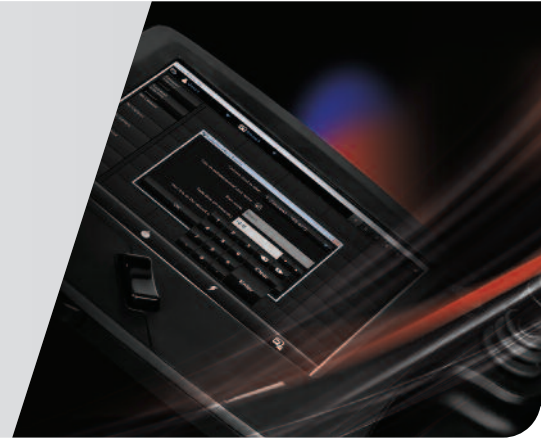

Technical Datasheet

### Rear Connectors - Pinout Specifications

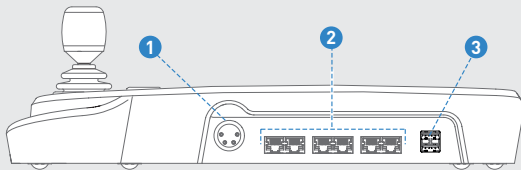

**Key:**

- 1. 4 pin Male XLR
- 2. 6 x RJ45 Ethernet ports
- 3. 2 x USB type A sockets

### System Connections

The diagram below shows a typical CP4 system installation with cameras mounted onto Fusion FHR-35 pan and tilt camera heads. A preview monitor is required to view the video signal from the camera currently selected on the CP4.

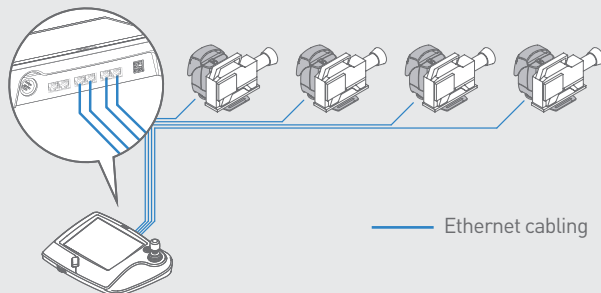

### Homepage Screen

Once logged on, the home screen page is displayed providing access to camera selection, control functions and configuration menus.

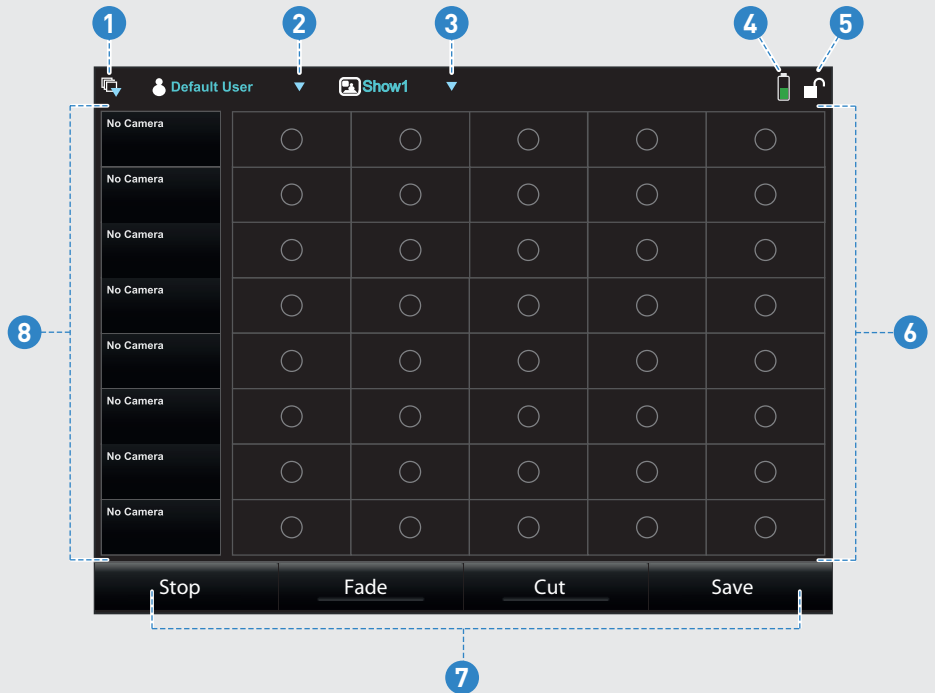

**Key:**

- 1. Main menu
- 2. User menu
- 3. Show menu
- 4. Battery status indicator
- 5. Panel lock/unlock button
- 6. Shot storage grid
- 7. Shot control buttons
- 8. Camera bin

### Software Features

Part Numbers			
Function	V4110-0001 Standard CP4	V4110-0003 Advanced Function Upgrade	
<b>Number of Heads</b>	4	8	Connect using the 6 Ethernet connectors at the rear of the CP4 panel and a powered Ethernet hub.
<b>Shot Naming</b>	Automatic	Editable	Shots may be names to make them more relevant and easier to find. Names can be up to 10 characters in length and may be edited.
<b>Camera Naming</b>	Automatic	Editable	Each name may be up to 10 characters in length. The name appears on the camera bin and stored shots.
<b>Number of Shows</b>	1	5	Each show can be renamed, saved or cleared.
<b>Shot Storage</b>	40	200	40 shots are stored on a grid page. The Advanced Function Upgrade provides 5 grids each storing 40 shots.
<b>Joystick Profiling</b>	Compound	Selectable	Allows each user to set the response of the camera head to the joystick movement. Profile options are linear, exponential or a combination of both (compound).
<b>User Logins</b>	1	4	Configuration settings, shots and shows are stored under each user name.

Technical Specification	
<b>Weight</b>	2 Kg / 4.4lbs
<b>Op temp</b>	-10°C to +40°C
<b>Power</b>	12V DC 30 W
<b>Touchscreen</b>	261.1 mm / 10.4 in
<b>Touchscreen resolution</b>	1024 x 768 pixels

Technical specifications are subject to change without notice. Vinten Radamec reserves the right, without notice, to make changes in equipment design or performance as progress in engineering, manufacturing or technology may warrant.

**Vinten Radamec**  
William Vinten Building, Western Way, Bury St Edmunds  
Suffolk IP33 3TB United Kingdom

T: +44 (0)1284 776700 (UK) T: (+1) 845 268 0100 (USA)

[www.vintenradamec.com](http://www.vintenradamec.com)